

ZAP6035



- Corrosion resistant die cast aluminium alloy.
- Thermal shock resistant safety glass.
- Weatherproof and durable silicone rubber gasket.
- Ultraviolet stabilized polyester powder coat finish in black, dark gray and light gray finish.
- Convenient to be used with COB led option.
- Designed for single-side light output.
- Luminaire can be installed in any burning position.
- All external screws are stainless steel.

- Korozyona dayanıklı alüminyum gövde.
- Paslanmaz çelik vida.
- Tamperli cam.
- Su geçirmezliği sağlayan plastik conta.
- Ultraviyole ışımaya dayanıklı beyaz, gri ve siyah elektrostatik toz boyalı.
- Tek taraftan ışık çıkışı olacak şekilde tasarlandı.
- Armatür aşağı veya yukarı bakacak şekilde istenildiği gibi monte edilebilir.
- Tüm dış vidalar paslanmaz çelik.



- Light Grey
- Black
- Textured Metallic
- Dark Grey

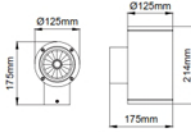

LED	COB LED
Led Power / Led Gücü	23W
System Power / Sistem Gücü	25W
Lumen Output from Fixture / Armatür Çıkış Lümeni CRI>80	2700K
	3000K
	4000K
	5000K
	2150
	2250
	2350
	2400

Beam Angle: 20° (Miro Silver)		
Distance (m)	Beam Diameter (m)	Flux (lm)
0.5	0.10	Ed(F) E(Cd)
		10.5° 20777
1.0	0.20	Ed(F) E(Cd)
		10.5° 5194
1.5	0.30	Ed(F) E(Cd)
		10.5° 2309
2.0	0.40	Ed(F) E(Cd)
		10.5° 1329
2.5	0.50	Ed(F) E(Cd)
		10.5° 831
3.0	0.60	Ed(F) E(Cd)
		10.5° 517

Beam Angle: 30° (Miro Silver)		
Distance (m)	Beam Diameter (m)	Flux (lm)
0.5	0.15	Ed(F) E(Cd)
		13.8° 17982
1.0	0.30	Ed(F) E(Cd)
		13.8° 4475
1.5	0.45	Ed(F) E(Cd)
		13.8° 3048
2.0	0.60	Ed(F) E(Cd)
		13.8° 2268
2.5	0.75	Ed(F) E(Cd)
		13.8° 1712
3.0	0.90	Ed(F) E(Cd)
		13.8° 1312

Beam Angle: 40° (Miro Silver)		
Distance (m)	Beam Diameter (m)	Flux (lm)
0.5	0.20	Ed(F) E(Cd)
		17.9° 8328
1.0	0.40	Ed(F) E(Cd)
		17.9° 2096
1.5	0.60	Ed(F) E(Cd)
		17.9° 1432
2.0	0.80	Ed(F) E(Cd)
		17.9° 1024
2.5	1.00	Ed(F) E(Cd)
		17.9° 772
3.0	1.20	Ed(F) E(Cd)
		17.9° 584

